

# Handwheel HST...

Designed as a compact star grip, this aluminium handwheel is intended to house position indicators.

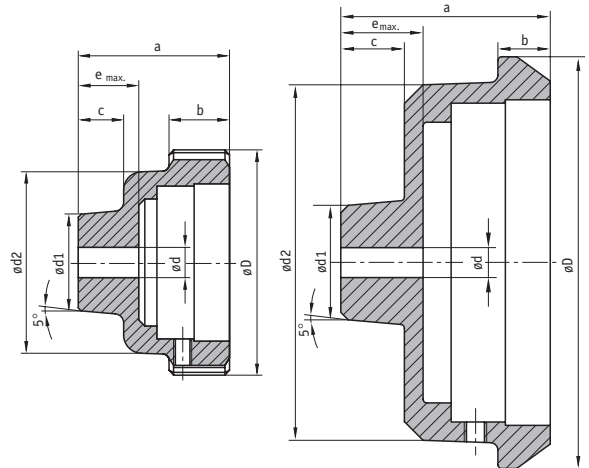

## Features:

- robust aluminium design

## Option:

- various hub options
- surface plastic coated

| Type   | øD  | ødv | ødx | ød1 | ød2 | a  | b  | c  | e  | Suitable for  | Weight |
|--------|-----|-----|-----|-----|-----|----|----|----|----|---------------|--------|
| HST 7  | 78  | 5.8 | 20  | 32  | 60  | 50 | 20 | 15 | 20 | S50/1         | 0.2 kg |
| HST 8  | 75  | 5.8 | 12  | 20  | 60  | 43 | 10 | 10 | 13 | S50/1         | 0.2 kg |
| HST 11 | 110 | 6.8 | 16  | 30  | 95  | 56 | 14 | 17 | 22 | S80/1; SZ80/1 | 0.5 kg |

dv = d pre-drilled; dx = d max.

| Feature                            | Ordering data           | Technical data   | Additional information  |
|------------------------------------|-------------------------|--|---|
| Handwheel                          | KHK...<br><b>A</b>      | see table above  |   |
| Surface                            | <b>B</b><br>CS          | <b>without varnish</b><br>plastic-coated, black RAL9005 half-matt<br>others on request | <b>standard</b><br>not for HST 7  |
| Bore ød                            | <b>d pre-dr.</b><br>... | <b>pre-drilled, see table above, value ødv</b><br>d max. in mm steps (H7)              | <b>standard</b><br>see table above (smallest bore corresponding to d pre-dr.) |
| Key groove                         | <b>OP</b><br>JS9<br>P9  | <b>without key groove</b><br>transition fit<br>press fit                               | <b>standard</b><br>acc. to DIN 6885 T1<br>acc. to DIN 6885 T1                 |
| Pin hole (only without key groove) | <b>OS</b><br>No. x ø/f  | <b>without pin hole</b><br>see fold-out page   | <b>standard</b><br>no. of pinholes x diameter/dimension f e.g. 2x3.8/12       |
| Hub thread                         | <b>ONG</b><br>No. x ø/f | <b>without hub thread</b><br>see fold-out page   | <b>standard</b><br>no. of hub threads x diameter/dimension f e.g. 2xM4/12     |
| Turned-down hub                    | <b>OAN</b><br>d1 (f7)xl | <b>without turned-down hub</b><br>see fold-out page                                    | <b>standard</b><br>dependent on d max.  |
| Position indicator mounted (*)     | <b>PM</b><br>PS         | <b>position indicator mounted</b><br>position indicator separate                       | <b>standard</b>   |
| Material                           |                         | aluminium  |   |

\* separate ordering of a position indicator necessary! (> see pages 9/10)

Your ordering data:  -  -  -  -  -  -  -  -