

# Handwheel HKF...

With its built-in position indicator, this handwheel of aluminium is designed for mounting on spindles of any orientation – and therefore suitable even for critical installation positions.

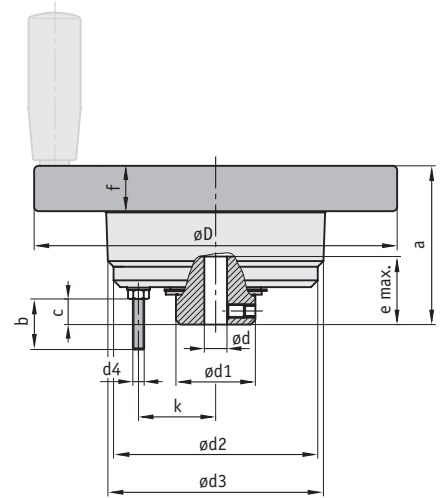

## Features:

- various sizes
- various gear ratios

## Option:

- various hub options
- easy mounting

	øD	ødv	ødx	ød1	ød2	ød3	d4	a	b	c	e	f	k	GfG	Weight
HKF12	120	6.8	20	35	90	95	M5	64	22.3	13.3	32	15	34	M6	1.0 kg
HKF16	160	7.8	20	35	90	95	M5	70	22.3	11.3	30	20	34	M8*	1.1 kg

dv = d pre-drilled; dx = d max.; GfG = thread for handle  
\*also with reversing handle possible, for this GfG = 6.4

Feature	Ordering data	Technical data	Additional information
Handwheel	HKF... <b>A</b>	see table above	
Surface	<b>C</b> KS	<b>B</b> plastic coated, hammer finish, light-grey plastic coated, black RAL9005 half-matt	<b>standard</b>
Handle bore	OG ...	<b>C</b> without handle bore with handle bore or handle thread	see table above, value GfG (or also 6.4 possible)
Bore ød	<b>d pre-dr.</b> ...	<b>D</b> pre-drilled, see table above, value ødv d max. in mm steps (H7)	<b>standard</b> see table above (smallest bore corresponding to d pre-dr.)
Key groove	<b>OP</b> JS9 P9	<b>E</b> without key groove transition fit press fit	<b>standard</b> acc. to DIN 6885 T1 acc. to DIN 6885 T1
Clamp ring	<b>OK</b> MK	<b>F</b> without clamp ring with clamp ring	<b>standard</b>
Gear ratio	...	<b>G</b> value see fold-out page	
Rotational direction	<b>I</b> E	<b>H</b> clockwise counter-clockwise	
Pointer	<b>1</b> 2	<b>I</b> pointer continuously geared one pointer geared and one pointer runs 1:1	
Zero reset	<b>ON</b> MN	<b>K</b> without with	<b>standard</b>
Scale	<b>N</b> VK	<b>L</b> normal scale special scale	<b>standard</b> , related to gear ratio customer specified, for 1st fabrication, no VK
Material		aluminium	

Your ordering data: **HKF...** - **A** - **B** - **C** - **D** - **E** - **F** - **G** - **H** - **I** - **K** - **L**