

# Digital Position Indicator DA09S

The most widely used counter in a compact design. The attenuated counter system for extended service life as well as the magnifying lense in the viewing window with significantly improved readability render this display universally usable.



## Features:

- axial seals, dust and hose-proof

## Option:

- Nirosta driving shaft
- counter cover made of mineral glass, solvent-resistant
- reduction sleeves for various diameters

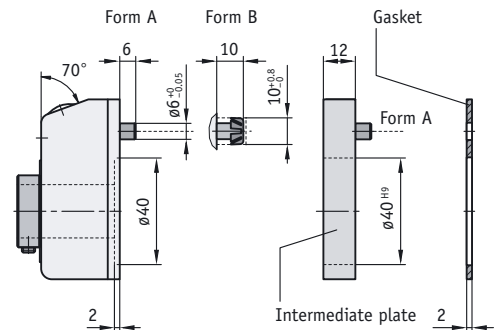
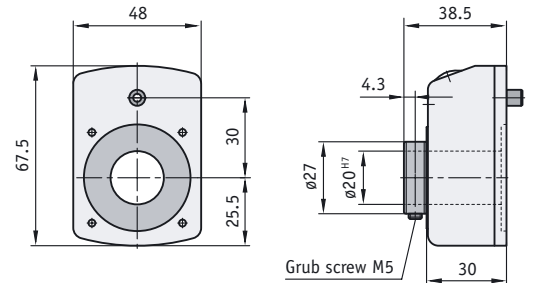

DA09S

Display after the first revolution	max. velocity (min <sup>-1</sup> )
00010	500 (1.500)
00015	500 (1.000)
00020	500 (750)
00025	500 (600)
00030	500
00040	375
00050	300
00060	250
00080	180
00100	150

**Caution:** velocities >500 min<sup>-1</sup> should be operated for a short while only.

$$\text{Formula for max. velocity} = \frac{15.000}{\text{display after the first revolution}}$$

Display	Mounting position				Counting direction
<p>Fine reading</p>	<p>02</p>	<p>04</p>	<p>06</p>	<p>07</p>	

For the DA09S, suitable reduction sleeves, an axial seal and intermediate plate are available (see Accessories)

Feature	Ordering data	Technical data	Additional information
Counting mechanism		5 decades, fine reading	
Digit height		approx. 7 mm	
Housing		plastic, dustproof	
Weight		0.1 kg	
Ambient temperature		max. +80 °C	

**Ordering data**

Version/mounting position	02 04 06 07	<b>A</b>		see the icons on the product page showing the mounting position
Display after the first revolution	...	<b>B</b>	10, 20, 25, 35, 40, 50, 60, 80, 100, 15/75 wide range of other values on request	/7 = arithmetical value not displayed
Comma position	0 1 2 3 4	<b>C</b>	0 = 00000 1 = 0000.0 2 = 000.00 3 = 00.000 4 = 0.0000	
Counting direct. = ascending values	i e	<b>D</b>	ascending values clockwise ascending values counter-clockwise	
Hollow-shaft diameter	...	<b>E</b>	20 VA8, VA10, VA14, VA20 RH8, RH10, RH12, RH14, RH18	stainless steel reduction sleeve
Housing colour	0 S GR FR	<b>F</b>	orange RAL 2004 black RAL 9005 grey RAL 7035 blazing red	<b>standard</b>
Torque pin/form	A B	<b>G</b>	form A form B	<b>standard</b>
Viewing window	K M OS	<b>H</b>	plastic mineral glass without viewing window	<b>standard</b>
Axial seal	OAD AD	<b>I</b>	without axial seal with axial seal	<b>standard</b> see "Important information in advance"
Intermediate plate	OZP ZP	<b>K</b>	without intermediate plate with intermediate plate	<b>standard</b>
Gasket	BP GK	<b>L</b>	enclosed glued	<b>standard</b>
Direction indicating arrow	ORP P/M M/P	<b>M</b>	without direction indicating arrow plus/minus minus/plus	<b>standard</b> see annex see annex

Your order:

-  -  -  -  -  -  -  -  -  -   
 -  -