

# Digital Position Indicator DA05/1

Robust and versatile digital indicator in a metal housing. Numerous special displays are available. The calibration screw additionally enables correction of measurements.



## Features:

- special indicated values
- attenuated counter system, therefore, increased service life

## Option:

- Nirosta driving shaft
- counter cover made of mineral glass, solvent-resistant
- reduction sleeves for various diameters

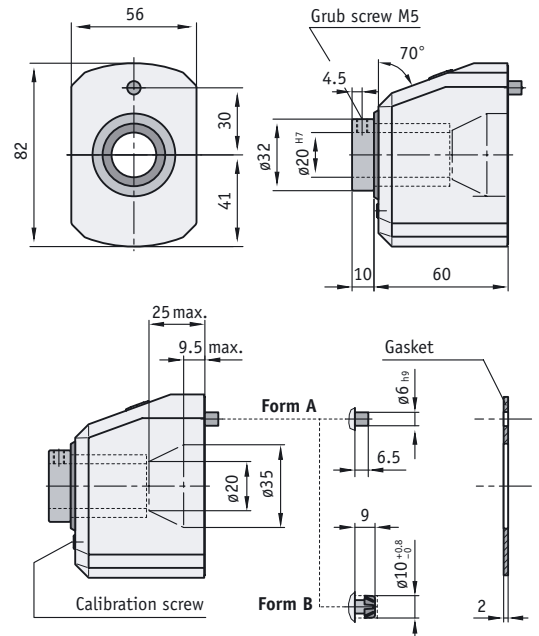

DA05/1

Display after the first revolution	max. velocity (min <sup>-1</sup> )
00010	500 (1.500)
00015	500 (1.000)
00020	500 (750)
00025	500 (600)
00030	500
00040	375
00050	300
00060	250
00080	180
00100	150

**Caution:** velocities > 500 min<sup>-1</sup> should be operated for a short while only.

Formula for max. velocity =  $\frac{15.000}{\text{display after the first revolution}}$

Display	Mounting position		Counting direction*
 Fine reading	 02	 04	

For the DA05/1, suitable reduction sleeves are available (see Accessories),

\*individually changeable counting direction

Feature		Technical data	Additional information
Counting mechanism		5 decades, fine reading	
Digit height		approx. 6.0 mm	
Housing		zinc die casting	
Weight		0.5 kg	
Counting direction		adjustable	
Display adjustment		by means of adjusting screw	
Ambient temperature		max. +80 °C, version/mounting position	
<b>Ordering data</b>			
Version/mounting position	02 04	<b>A</b>	see the icons on the product page showing the mounting position
Display after the first revolution	...	<b>B</b> 10, 20, 25, 35, 40, 50, 60, 80, 100, 15/7 wide range of other values on request	/7 = arithmetical value not displayed
Comma position	0 1 2 3 4	<b>C</b> 0 = 00000 1 = 0000.0 2 = 000.00 3 = 00.000 4 = 0.0000	
Counting direct. = ascending values	i e e/i	<b>D</b> ascending values clockwise ascending values counter-clockwise adjustable by the customer	by opening the housing, see annex
Hollow-shaft diameter in mm	...	<b>E</b> 20, 19.05, 19 RH6, RH8, RH10, RH12, RH14 RH16, RH17.5, RH18	reduction sleeve reduction sleeve
Housing colour	0 S R FR rev	<b>F</b> orange RAL 2004 black RAL 9005 red RAL 3004 blazing red RAL 3000 unvarnished	<b>standard</b>
Calibration screw	FE OFE	<b>G</b> with calibration screw without calibration screw	<b>standard</b>
Slip clutch	RK ORK	<b>H</b> with slip clutch without slip clutch	<b>standard</b>
Torque pin/form	A B	<b>I</b> form A form B	<b>standard</b>
Labyrinth seal	OLD LD	<b>K</b> without labyrinth seal with labyrinth seal	<b>standard</b>

Your order:  -  -  -  -  -  -  -  -  -  -